

Holding No. 10, Boral Main Road, Ward No.- 034 under Rajpur Sonarpur Municipality, P.O.-Boral, P.S-Narendrapur (Previously Sonarpur), District-South 24 PGS, Kolkata-700154.

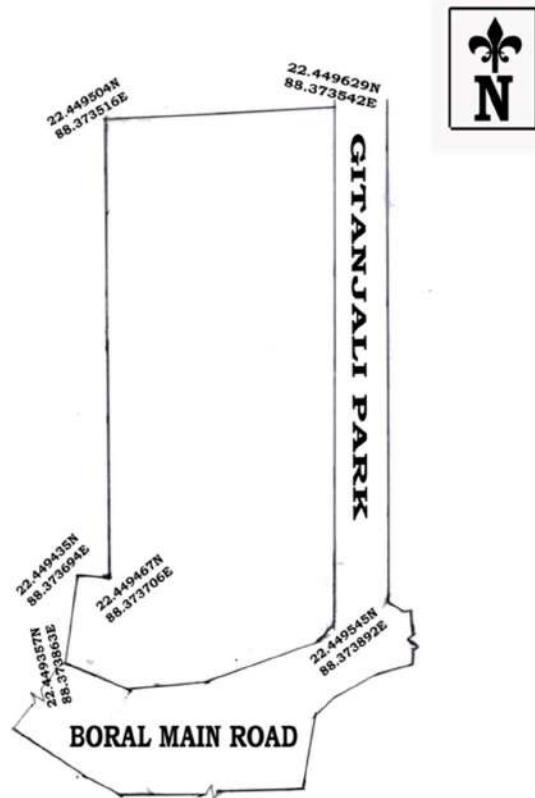

SITE PLAN WITH LATITUDE LONGITUDE

LAT: 22.45132 N
LONG: 88.37565 E

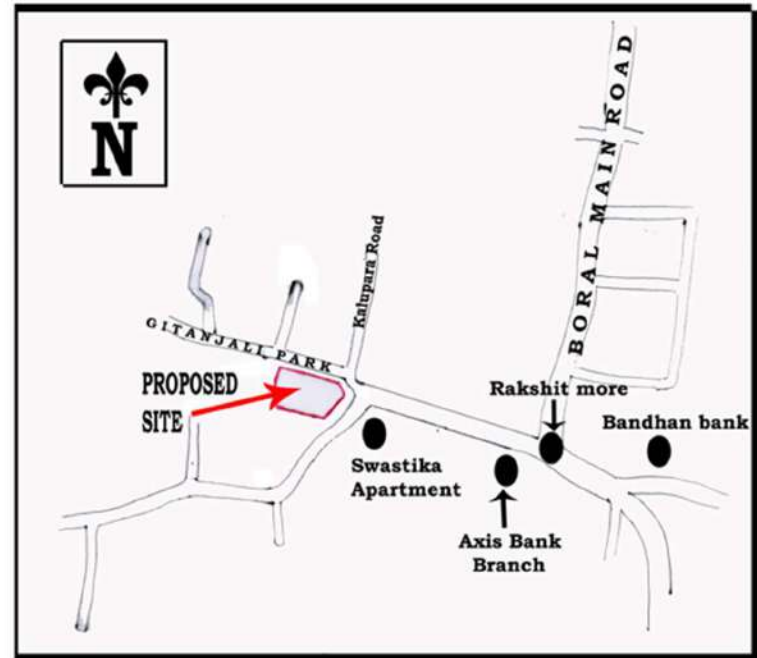

LOCATION PLAN WITH ROAD MAP

NARAYANI CONSTRUCTION
[Signature]
Proprietor